

- 本手册由温州普尼达机床附件有限公司印制，仅用于说明部分产品相关的资料信息随时因技术升级或采用新的生产工艺而改进本手册相关内容，恕不另行通知商家订货时请随时联系本公司，以证实相关信息。
- 未经许可，禁止全部或部分复制。
- 产品不断研发，技术持续创新……
- This manual is printed by WENZHOU PUNIDA MACHINE TOOL ACCESSORIES CO., LTD. and is only used to explain the information of some products. At any time, due to technical upgrading or adopting new production process, the contents of this manual are subject to change without notice. Please contact us when ordering Our company. To confirm the relevant information.
- It is prohibited to copy in whole or in part without permission.
- product research and development, technology innovation ...

🌿 珍惜资源，善待环境 Cherish resources, treat the environment

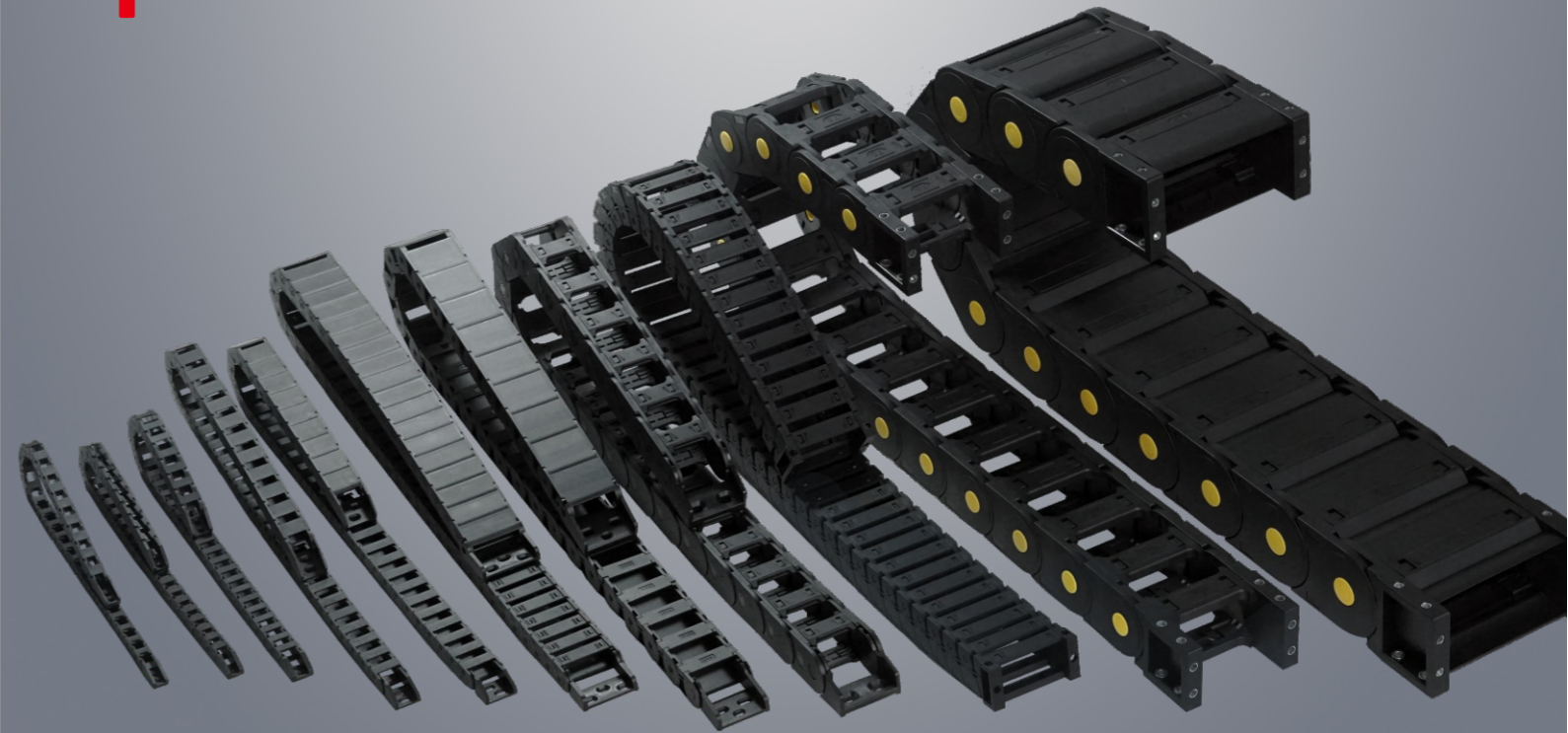

pund®



PRODUCT MODEL
NYLON DRAG CHAIN SERIES
产品选型 | 尼龙拖链系列

诚信为本 质量立足
Integrity based on the
quality of foothold



温州普尼达机床附件有限公司

WENZHOU PUNIDA MACHINE TOOL ACCESSORIES CO., LTD.

销售地址：五洲·中国电工电器城C区33栋-316号

Sales Address: Wuzhou · CEC 33, Building C, No.316

工厂地址：乐清市北白象下库工业区

Factory Address: North White Elephant Yueqing Industrial Zone

邮箱：691615335@qq.com

E-mail: 691615335@qq.com



☎ 0577-62876815 📠 13356150099

温州普尼达机床附件有限公司
WENZHOU PUNIDA MACHINE TOOL ACCESSORIES CO., LTD.

INTRODUCTION

企业简介

温州普尼达机床附件有限公司是一家致力于工业自动化设备电气连接保护系统产品的研发、生产、销售。专业生产各种规格的机床拖链。

生产的尼龙拖链，具有外型美观、结构牢固、耐磨耐压、噪音低的特点。广泛适用于数控机床、纺织机械、玻璃机械、机械手、注塑机械、木材机械、石材机械、起重机械等自动化设备。适用于往复运动场合应用，能够对内置的电线电缆、气管、水管、油管等起到整理、牵引和保护作用。

如需特殊规格拖链，可为客户定做。

我们坚持一质量为重点，以客户为中心，以创新为动力，以信誉致上的经营方针，为工业自动化发展出一份力量。欢迎新老顾客光临洽谈！

Wenzhou Punida Machine Tool Accessories Co., Ltd. is a research and development, production and sales of electrical connection protection system products dedicated to industrial automation equipment. Specializing in the production of a variety of machine towline.

Production of nylon towline, with good looks, solid structure, wear pressure, low noise characteristics. Widely used in CNC machinery, textile machinery, glass machinery, manipulators, injection molding machinery, wood machinery, stone machinery, lifting machinery and other automation equipment. It is suitable for reciprocating applications. It can finish, pull and protect built-in wire and cable, air pipe, water pipe and tubing.

For special specifications towline, can be customized.

We insist on a focus on quality, customer-focused, innovation-driven, credit-oriented business principles, to develop a force for industrial automation. Welcome new and old customers visit negotiate!



品牌专卖店





广泛应用于工业自动化领域
Application field

ENERGYCHAIN SYSTEMS

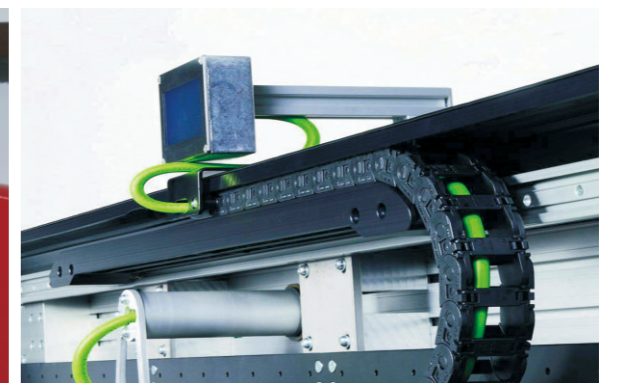

pund®

CONTENTS

产品目录

P.01 微型7系列-桥式不可打开	P.09 H20系列-桥式两侧可打开	P.17 H45系列-桥式两侧可打开
P.02 微型10系列-便捷式、桥式	P.10 H20系列-封闭式两侧可打开	P.18 H45系列-封闭式两侧可打开
P.03 10系列-不可打开	P.11 H25系列-桥式两侧可打开	P.19 H55系列-桥式两侧可打开
P.04 15系列-半封闭内侧打开	P.12 H25系列-封闭式两侧可打开	P.20 H55系列-封闭式两侧可打开
P.05 18系列-半封闭内侧打开	P.13 H30系列-桥式两侧可打开	P.21 H65系列-桥式两侧可打开
P.06 S25静音系列-桥式两侧可打开	P.14 H30系列-封闭式两侧可打开	P.22 H65系列-封闭式两侧可打开
P.07 J25系列-桥式两侧可打开	P.15 H35系列-桥式两侧可打开	
P.08 J25系列-封闭式两侧可打开	P.16 H35系列-封闭式两侧可打开	

微型7系列-不可打开

Mini 7 Series – can not be opened

pund®



主要技术参数 Basic technical data

节距=17mm, 每米节数=59, 链长=S/2+K, S=行程距离, K=π.R+“安全量”
Pitch = 17 mm, number of sections per meter = 59, chain length = S / 2 + K, S = travel distance, K = π .R + "safe amount"

示意图 Delineation

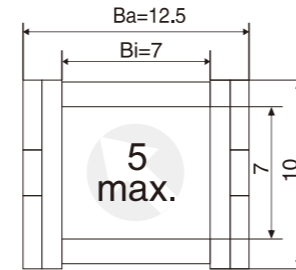

R	15	28
H	40	66
D	37	62
K	52	105

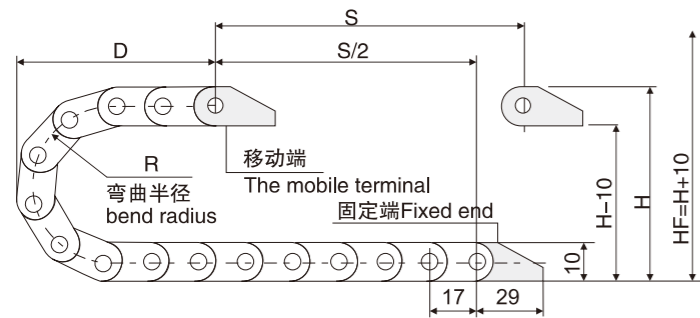

接头安装尺寸图 Connector installation dimensions

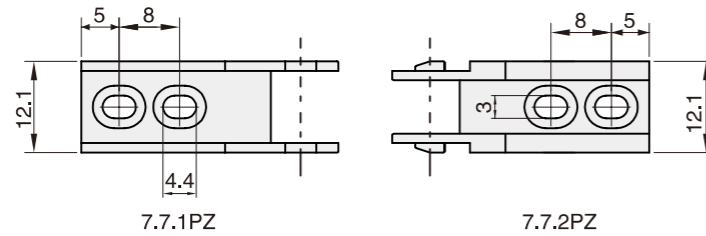

微型7系列-不可打开 Mini 7 Series – can not be opened

系列号 Serial No.	内高 Hi	内宽 Bi	外高 H	外宽 Ba	弯曲半径(R) Bending radius	打开方式 Open the way	对应接头孔距(mm) Corresponds to the hole pitch	接头订购型号 Connector ordering model
7	7	7	10	12.5	15 28	B	A=8	7.7.B.1PZ/2PZ

注: 打开方式B为不可打开型。

接头型号: 7...B.12PZ=U型斜角接头全套; 7...B.1PZ=一端带孔; 7...B.2PZ=一端带销。

Note: Open mode B is not open type.

Connector type: 7 ... B.12PZ = Complete U-shaped bevel connector; 7 ... B.1PZ = One end with hole; 7 ... B.2PZ = One end with pin.

微型10系列-便捷式/桥式

Mini 10 Series – Convenient/Bridge

pund®

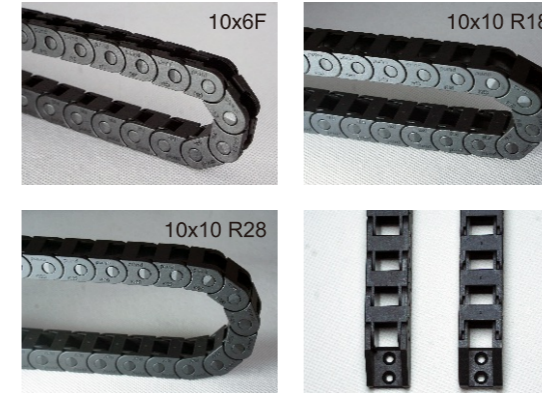

主要技术参数 Basic technical data

节距=15mm, 每米节数=66, 链长=S/2+K, S=行程距离, K=π.R+“安全量”
Pitch = 15 mm, number of sections per meter = 66, chain length = S / 2 + K, S = travel distance, K = π .R + "safe amount"

示意图 Delineation

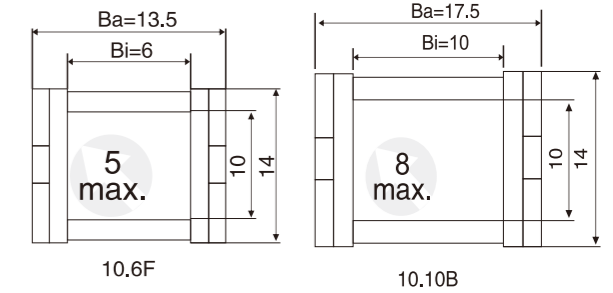

R	18	28
H	50	70
D	45	55
K	72	103

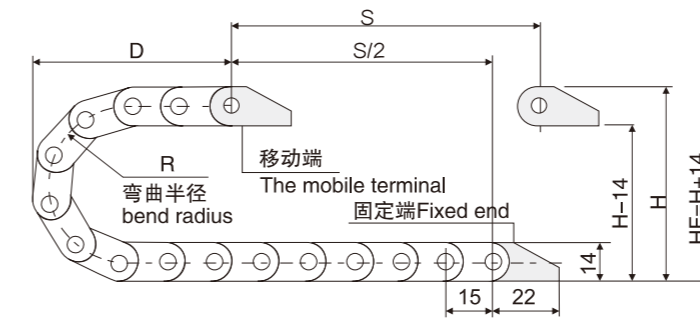

接头安装尺寸图 Connector installation dimensions

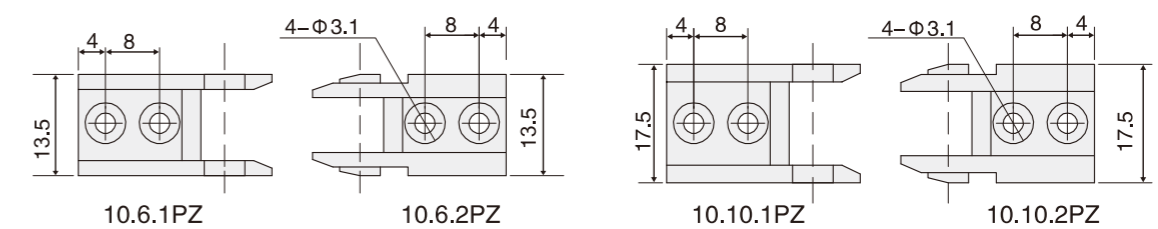

微型10系列-不可打开 Mini 10 Series – can not be opened

系列号 Serial No.	内高 Hi	内宽 Bi	外高 H	外宽 Ba	弯曲半径(R) Bending radius	打开方式 Open the way	对应接头孔距(mm) Corresponds to the hole pitch	接头订购型号 Connector ordering model
10型便捷式	10	6	14	13.5	18	F	A=8	10.6.F.1PZ/2PZ
10型桥式	10	10	14	17.5	18 28	B	A=8	10.10.B.1PZ/2PZ

注: 打开方式B为不可打开型, F为外侧便捷式。

接头型号: 10...B.12PZ=U型斜角接头全套; 10...B.1PZ=一端带孔; 10...B.2PZ=一端带销。

Note: Open mode B is not open type.

Connector type: 10 ... B.12PZ = Complete U-shaped bevel connector; 10 ... B.1PZ = One end with hole; 10 ... B.2PZ = One end with pin.

10系列-不可打开

Mini 10 Series – can not be opened



主要技术参数 Basic technical data

节距=20mm, 每米节数=50, 链长=S/2+K, S=行程距离, K=π.R+“安全量”
Pitch = 20 mm, number of sections per meter = 50, chain length = S / 2 + K, S = travel distance, K = π .R + "safe amount"

示意图 Delineation

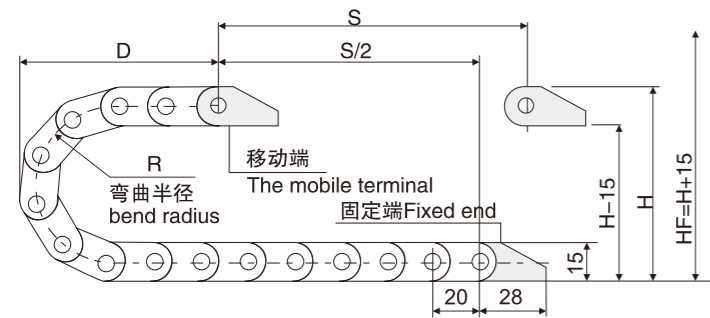
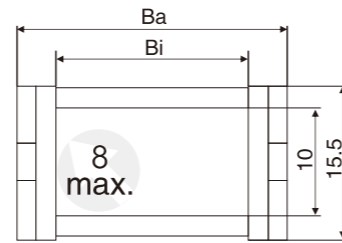

R	18	28	38
H	52	72	92
D	45	55	65
K	100	140	160

接头安装尺寸图 Connector installation dimensions

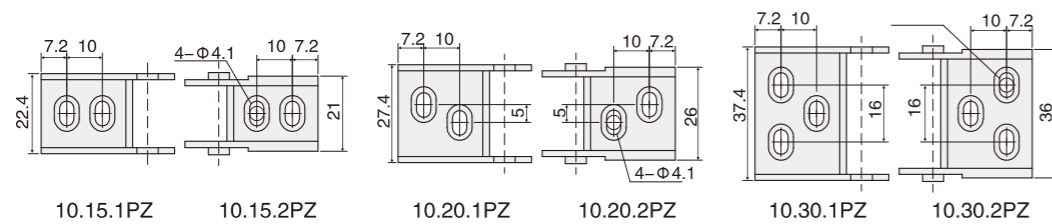

10系列-不可打开 Mini 10 Series – can not be opened

系列号 Serial No.	内高 Hi	内宽 Bi	外高 H	外宽 Ba	弯曲半径(R) Bending radius	打开方式 Open the way	对应接头孔距(mm) Corresponds to the hole pitch	接头订购型号 Connector ordering model
10	10	15	15.5	23	18 28 38	Q、BF	A=10	10.15.B.1PZ/2PZ
	10	20	15.5	28		Q、BF	A=10 B=5	10.20.B.1PZ/2PZ
	10	30	15.5	38		Q、BF	A=10 B=16	10.30.B.1PZ/2PZ

注：打开方式Q为桥式不可打开型，BF为半封闭不可打开型。

接头型号：10...B.12PZ=U型斜角接头全套；10...B.1PZ=一端带孔；10...B.2PZ=一端带销。

Note: Open mode B is not open type.

Connector type: 10 ... B.12PZ = Complete U-shaped bevel connector; 10 ... B.1PZ = One end with hole; 10 ... B.2PZ = One end with pin.

15系列-半封闭内侧打开

Series 15 - Semi-enclosed open inside



主要技术参数 Basic technical data

节距=20mm, 每米节数=50, 链长=S/2+K, S=行程距离, K=π.R+“安全距离”
Pitch = 20 mm, number of sections per meter = 50, chain length = S / 2 + K, S = stroke distance, K = π .R + "safety distance"

示意图 Delineation

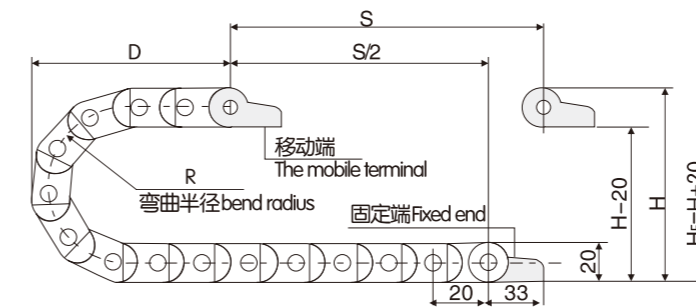
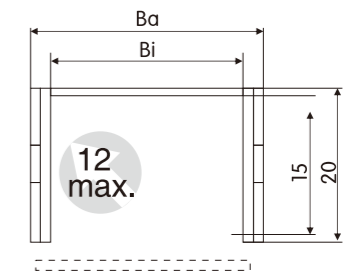

R	28	38	48
H	76	96	116
D	60	70	80
K	130	160	190

接头安装尺寸图 Connector installation dimensions

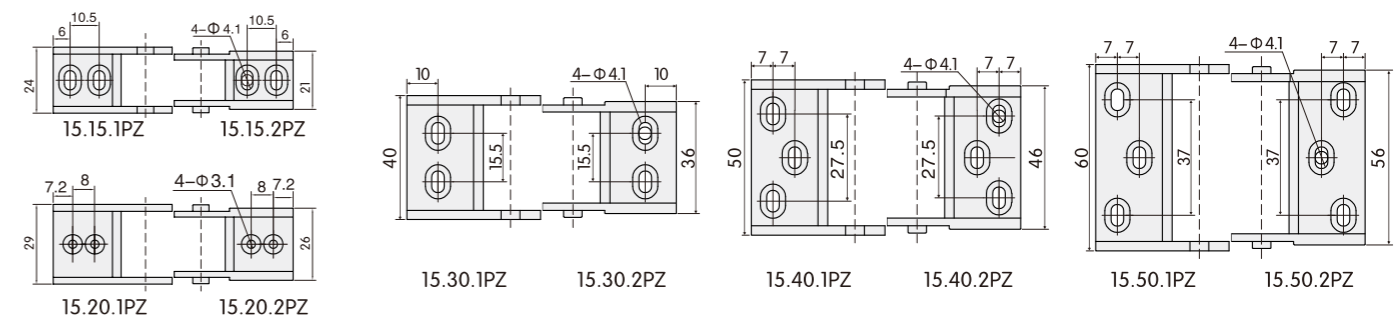

15系列-半封闭内侧打开 Series 15 – Semi-enclosed open inside

系列号 Serial No.	内高 Hi	内宽 Bi	外高 H	外宽 Ba	弯曲半径(R) Bending radius	打开方式 Open the way	对应接头孔距(mm) Corresponds to the hole pitch	接头订购型号 Connector ordering model
15	15	15	20	23	28 38 48	BF.N	A=10.5	15.15.1PZ/2PZ
	15	20	20	28		BF.N	B=8	15.20.1PZ/2PZ
	15	30	20	38		BF.N	B=15.5	15.30.1PZ/2PZ
	15	40	20	48		BF.N	A=7 B=27.5	15.40.1PZ/2PZ
	15	50	20	58		BF.N	A=7 B=37	15.50.1PZ/2PZ

注：打开方式BF为半封闭型，N为内侧打开型，BF.N为半封闭内侧打开型。

接头型号：15...12PZ=U型斜角接头全套；15...1PZ=一端带孔；15...2PZ=一端带销。

Note: The opening method BF is semi-closed type, N is the inside open type, BF.N is the semi-closed inside open type.

Connector type: 15 ... 12PZ = Complete U-shaped bevel connector; 15 ... 1PZ = One end with hole; 15 ... 2PZ = One end with pin.

18系列-半封闭内侧打开

18 Series - Semi-closed inside open

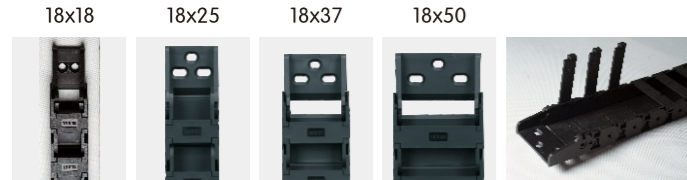
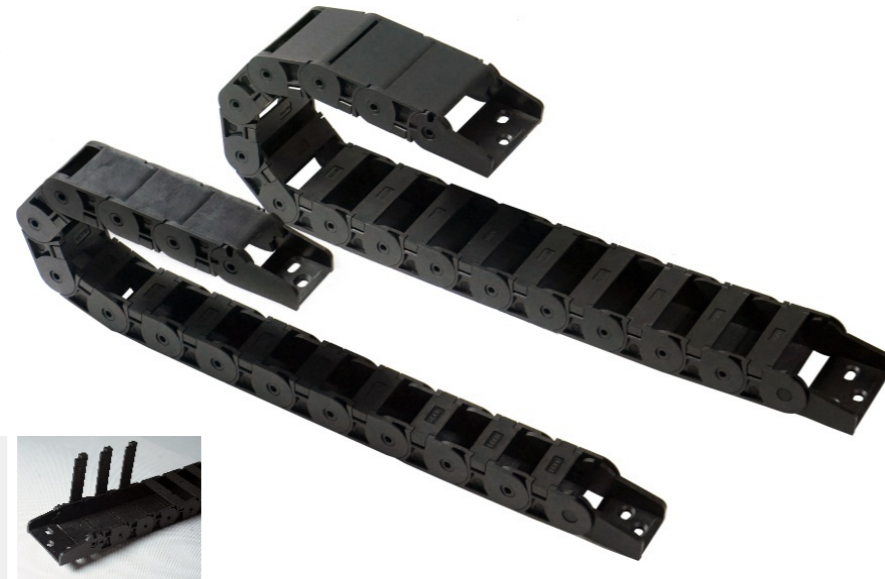

主要技术参数 Basic technical data

节距=34mm, 每米节数=30, 链长=S/2+K, S=行程距离, K=π.R+“安全量”
 Pitch = 34 mm, number of sections per meter = 30, chain length = S / 2 + K,
 S = travel distance, K = π . R + "safe amount"

示意图 Delineation

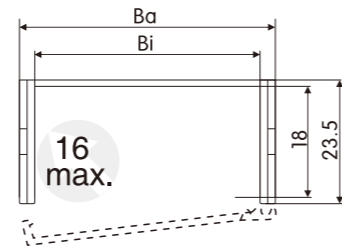

R	28	38	48	60*	75	100*
H	80	100	120	145	175	225
D	70	80	90	100	120	145
K	150	185	215	250	300	375

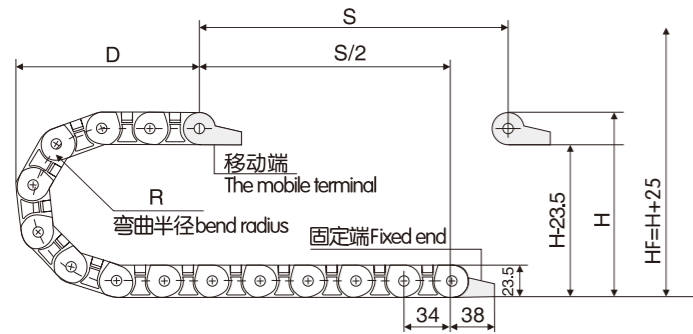

接头安装尺寸图 Connector installation dimensions

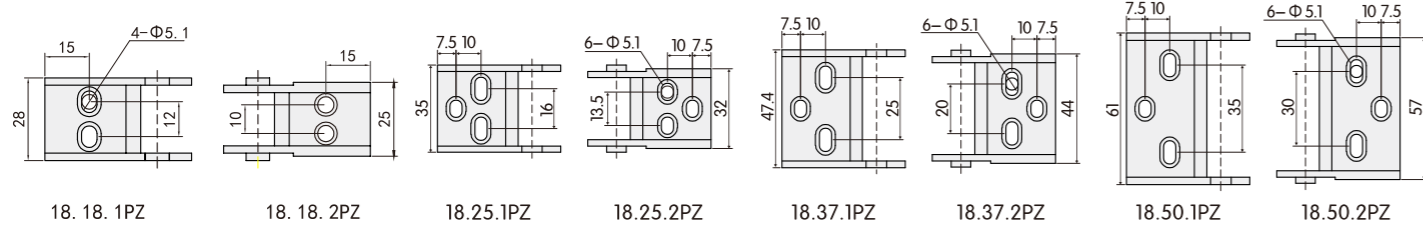

18系列-半封闭内侧打开 18 Series - Semi-closed inside open

系列号 Serial No.	内高 Hi	内宽 Bi	外高 H	外宽 Ba	弯曲半径(R) Bending radius	打开方式 Open the way	对应接头孔距(mm) Corresponds to the hole pitch	接头订购型号 Connector ordering model
18	18	18	23.5	28	28 38 48 60* 75 100*	BF.N	B1=10 B2=12	18.18.1PZ/2PZ
	18	25	23.5	35		BF.N	A=10 B1=16 B2=13.5	18.25.1PZ/2PZ
	18	37	23.5	47		BF.N	A=10 B1=25 B2=20	18.37.1PZ/2PZ
	18	50	23.5	60		BF.N	A=10 B1=35 B2=30	18.50.1PZ/2PZ

注: 打开方式BF为半封闭型, N为内侧打开型, BF.N为半封闭内侧打开型。

接头型号: 18...12PZ=U型斜角接头全套; 18...1PZ=一端带孔; 18...2PZ=一端带销。

Note: The opening method BF is semi-closed type, N is the inside open type, BF.N is the semi-closed inside open type.
 Coupling type: 18 ... 12PZ = Complete set of U-type bevel joints; 18 ... 1PZ = One end with hole; 18 ... 2PZ = One end with pin.



S25系列-静音桥式两侧可打开

S25 Series - Silent bridge can be opened on both sides

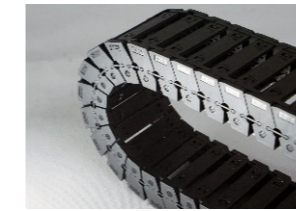
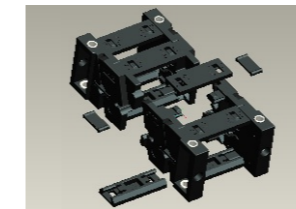
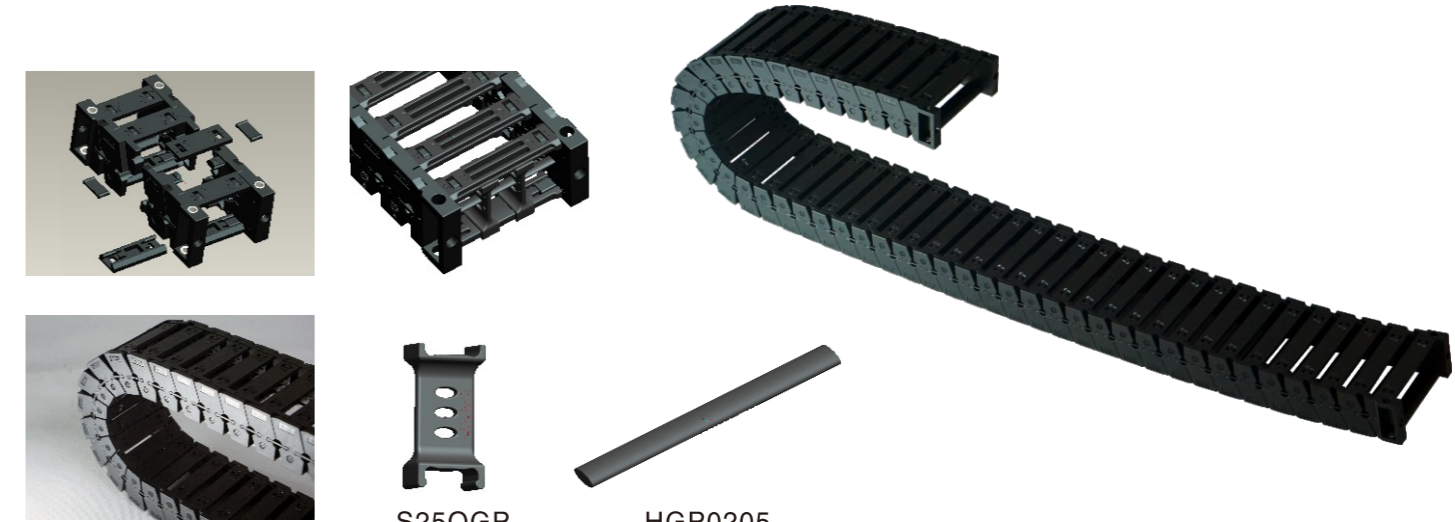

S25QGP



HGP0205

主要技术参数 Basic technical data

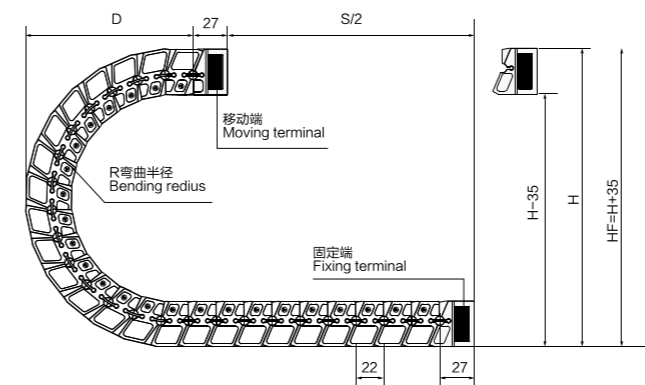

节距=22mm, 每米节数=46, 链长=S/2+K, S=行程距离, K=π.R+“安全量”
 Pitch = 22mm, number of meters per meter = 46,
 chain length = S / 2 + K, S = travel distance, K = π . R + "safety"

R	55	75	100
H	145	185	235
D	125	150	175
K	276	346	414

接头安装尺寸图 Connector installation dimensions

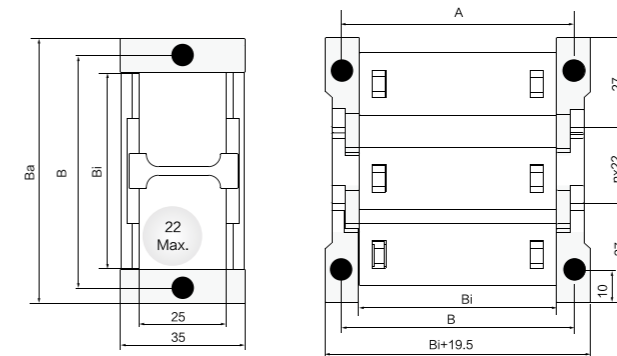

S25系列-静音桥式两侧可打开 25 series - silent bridge can be opened on both sides

系列号 Serial No.	内高 Hi	内宽 Bi	外高 H	外宽 Ba	弯曲半径(R) Bending radius	打开方式 Open the way	对应接头孔距(mm) Corresponds to the hole pitch	接头订购型号 Connector ordering model
S25	25	25	35	42	55 75 100	M	B=35	S25Q.25.12PZ
	25	38	35	55		M	B=48	S25Q.38.12PZ
	25	50	35	67		M	B=60	S25Q.50.12PZ
	25	57	35	74		M	B=67	S25Q.57.12PZ
	25	77	35	94		M	B=87	S25Q.77.12PZ
	25	103	35	120		M	B=113	S25Q.103.12PZ

J25系列-桥式两侧可打开

J25 Series – Both sides of the bridge open

pund®

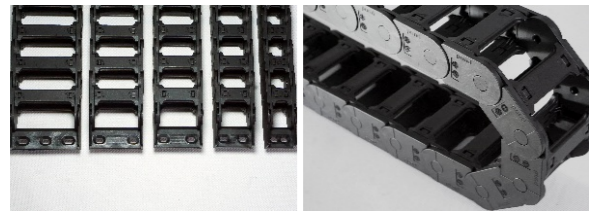

J25QGP

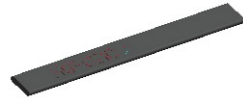

HGP0210

主要技术参数 Basic technical data

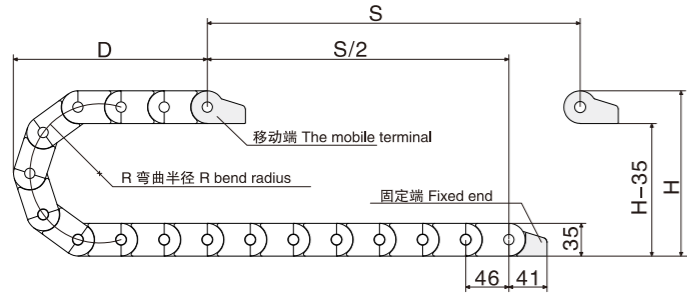

R	40	55	75	100	125	150	200
H	115	145	185	235	285	335	335
D	100	105	110	140	155	190	250
K	297	344	407	485	564	642	750

示意图 Delineation

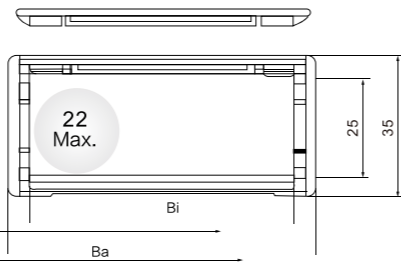

节距 = 46mm, 每米节数 = 22, 链长 = S/2+K, S=行程距离, K=π.R+"安全量"+1节距
Pitch = 46 mm, number of sections per meter = 22, chain length = S / 2 + K, S = stroke distance, K = π.R + "safe amount" + 1 pitch

接头安装尺寸图 Connector installation dimensions

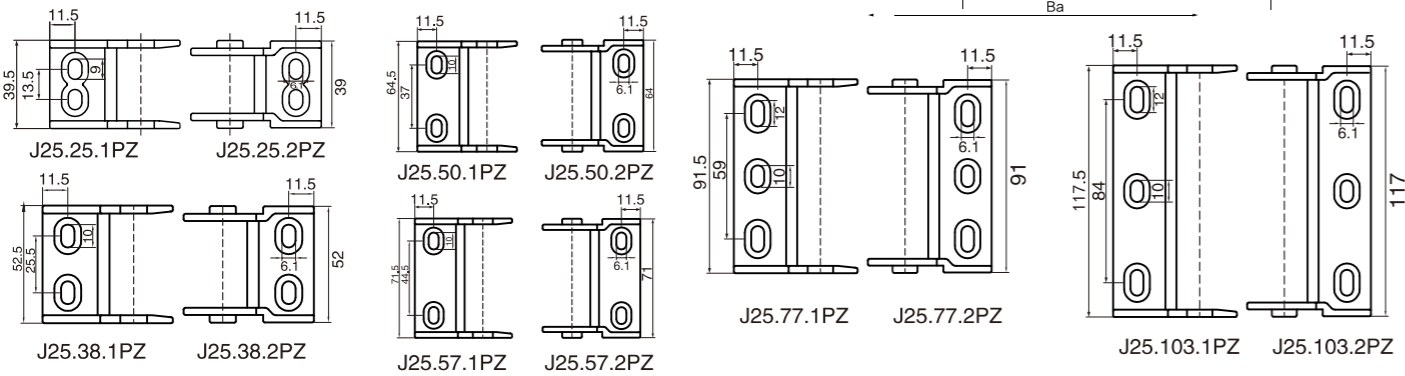

J25系列-桥式两侧可打开 J25 Series – Both sides of the bridge open

系列号 Serial No.	内高 Hi	内宽 Bi	外高 H	外宽 Ba	弯曲半径(R) Bending radius	打开方式 Open the way	对应接头孔距(mm) Corresponds to the hole pitch	接头订购型号 Connector ordering model
J25	25	25	35	39	40 55 75 100 125 150 200	S	B=13.5	J25.25.Q.12PZ
	25	38	35	52		S	B=25.5	J25.38.Q.12PZ
	25	50	35	64		S	B=37	J25.50.Q.12PZ
	25	57	35	71		S	B=44.5	J25.57.Q.12PZ
	25	77	35	91		S	B=59	J25.77.Q.12PZ
	25	103	35	117		S	B=84	J25.103.Q.12PZ

J25系列-封闭两侧可打开

Series H25 – Closed to open on both sides

pund®



主要技术参数 Basic technical data

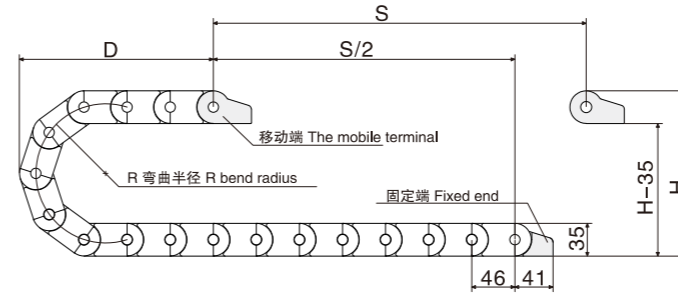

R	55	75	100	125	150	200
H	145	185	235	285	335	335
D	105	110	140	155	190	250
K	344	407	485	564	642	750

示意图 Delineation

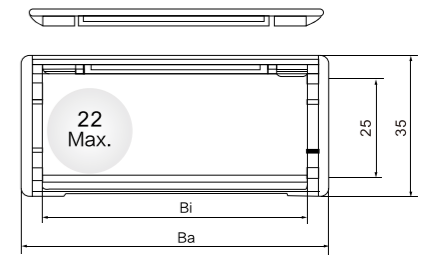

节距 = 46mm, 每米节数 = 22, 链长 = S/2+K, S=行程距离, K=π.R+"安全量"+1节距
Pitch = 46 mm, number of sections per meter = 22, chain length = S / 2 + K, S = stroke distance, K = π.R + "safe amount" + 1 pitch

接头安装尺寸图 Connector installation dimensions

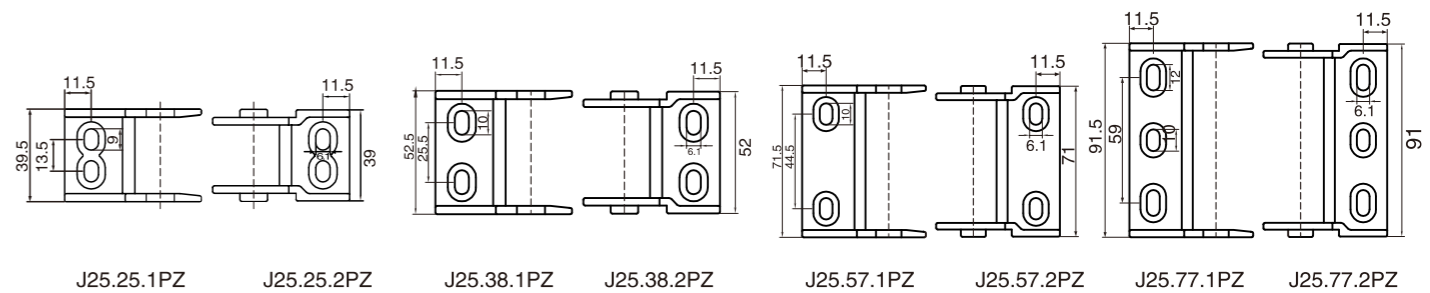

J25系列-封闭两侧可打开 Series J25 – Closed to open on both sides

系列号 Serial No.	内高 Hi	内宽 Bi	外高 H	外宽 Ba	弯曲半径(R) Bending radius	打开方式 Open the way	对应接头孔距(mm) Corresponds to the hole pitch	接头订购型号 Connector ordering model
J25	25	25	35	39	55 75 100 125 150 200	S	B=13.5	J25.25.F.12PZ
	25	38	35	52		S	B=25.5	J25.38.F.12PZ
	25	57	35	71		S	B=44.5	J25.57.F.12PZ
	25	77	35	91		S	B=59	J25.77.F.12PZ

H20系列-桥式两侧可打开

H20 Series – Both sides of the bridge open

pund®

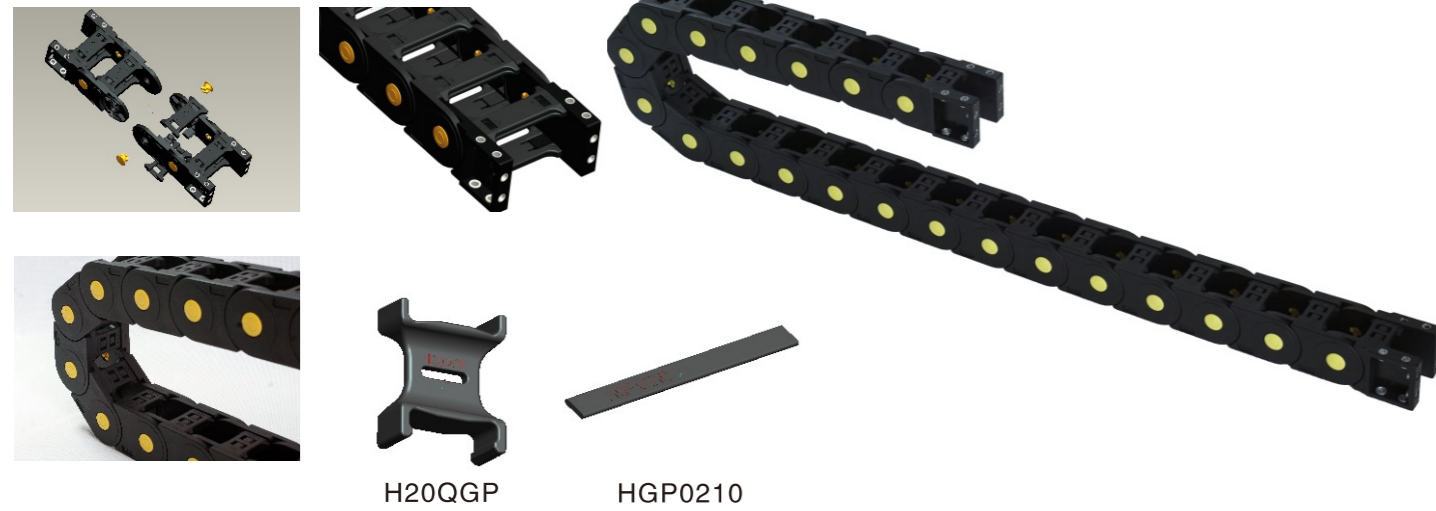

H20QGP

HGP0210

主要技术参数 Basic technical data

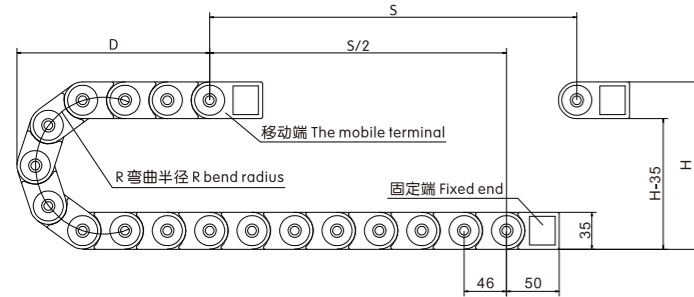

R	55	75	100	125	150
H	145	185	235	285	335
D	100	115	135	150	185
K	328	392	470	550	630

节距 = 46mm, 每米节数 = 22, 链长 = S/2+K, S=行程距离, K=π.R+"安全量"+1节距

Pitch = 46 mm, number of sections per meter = 22, chain length = S / 2 + K, S = stroke distance, K = π .R + "safe amount" +1 pitch

示意图 Delineation

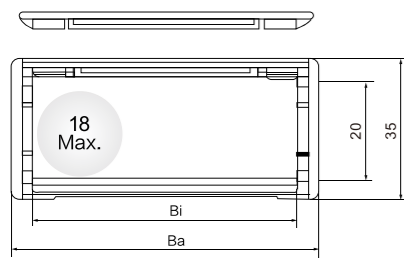

接头安装尺寸图 Connector installation dimensions

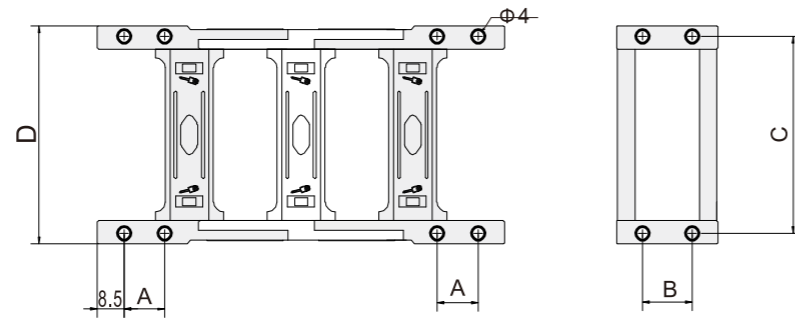

H20系列-桥式两侧可打开 20 Series – Both sides of the bridge open

系列号 Serial No.	内高 Hi	内宽 Bi	外高 H	外宽 Ba	A	B	C	D	孔径(mm) Hole distance	孔边距 (mm) Hole margin
H20	20	25	35	45	15	15	37	46	4	8.5
	20	38	35	58	15	15	50	59	4	8.5
	20	50	35	70	15	15	62	71	4	8.5
	20	57	35	77	15	15	69	81	4	8.5
	20	60	35	80	15	15	72	81	4	8.5
	20	75	35	95	15	15	87	96	4	8.5
	20	77	35	97	15	15	89	98	4	8.5
	20	100	35	120	15	15	112	121	4	8.5
	20	103	35	123	15	15	115	124	4	8.5

H20系列-封闭两侧可打开

Series H20 – Closed to open on both sides

pund®



主要技术参数 Basic technical data

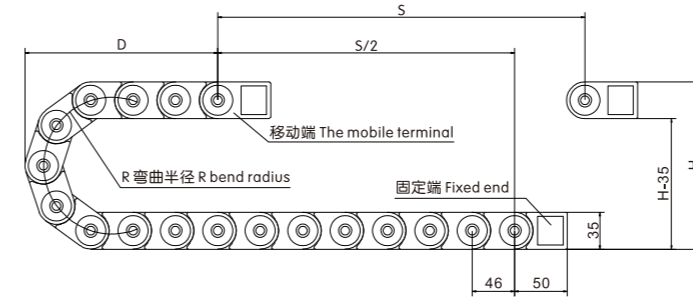

R	55	75	100	125	150
H	145	185	235	285	335
D	100	115	135	150	185
K	328	392	470	550	630

节距 = 46 mm, 每米节数 = 22, 链长 = S/2+K, S=行程距离, K=π.R+"安全量"+1节距

Pitch = 46 mm, number of sections per meter = 22, chain length = S / 2 + K, S = stroke distance, K = π .R + "safe amount" +1 pitch

示意图 Delineation

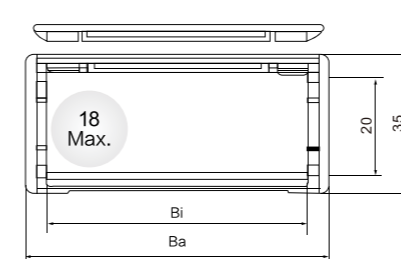

接头安装尺寸图 Connector installation dimensions

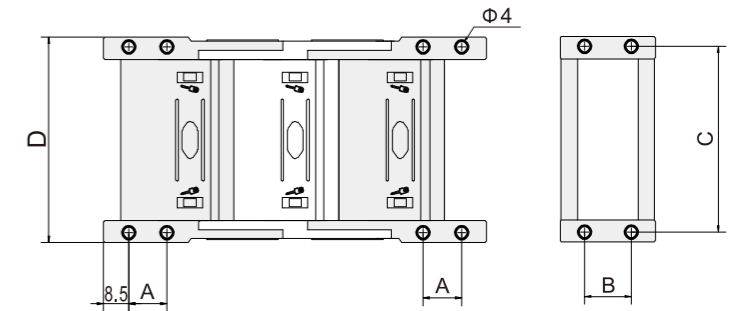

H20系列-封闭两侧可打开 Series 20 – Closed to open on both sides

系列号 Serial No.	内高 Hi	内宽 Bi	外高 H	外宽 Ba	A	B	C	D	孔径(mm) Hole distance	孔边距 (mm) Hole margin
H20	20	38	35	58	15	15	50	59	4	8.5
	20	50	35	70	15	15	62	71	4	8.5
	20	60	35	80	15	15	72	81	4	8.5
	20	75	35	95	15	15	87	96	4	8.5

H25系列-桥式两侧可打开

H25 Series - Both sides of the bridge open

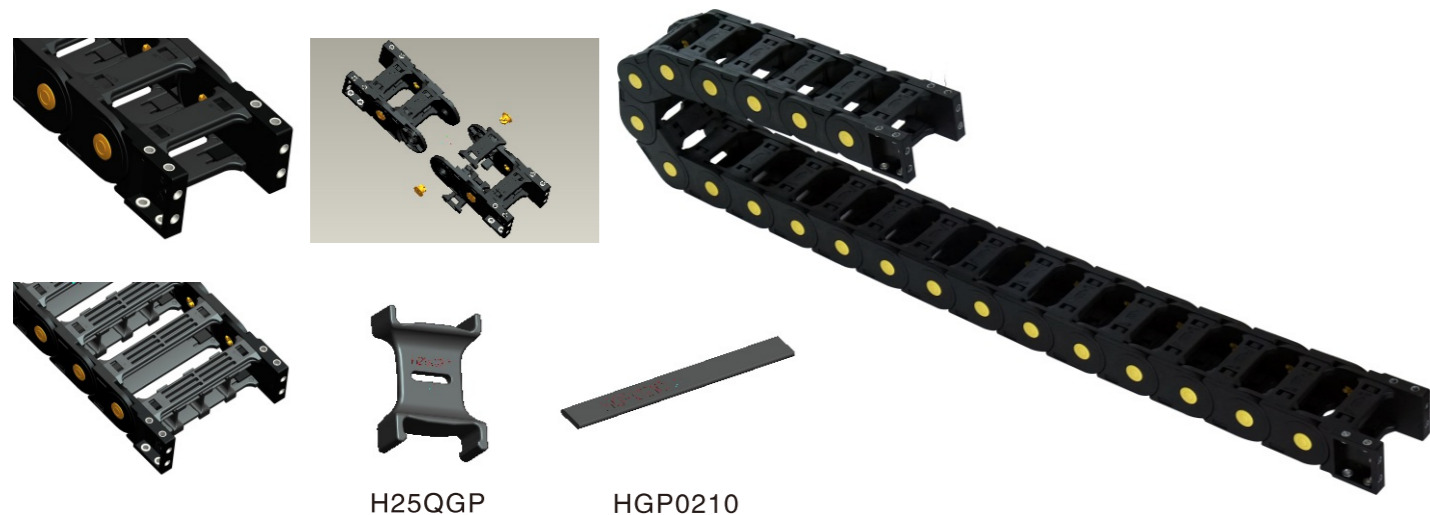

H25QGP

HGP0210

主要技术参数 Basic technical data

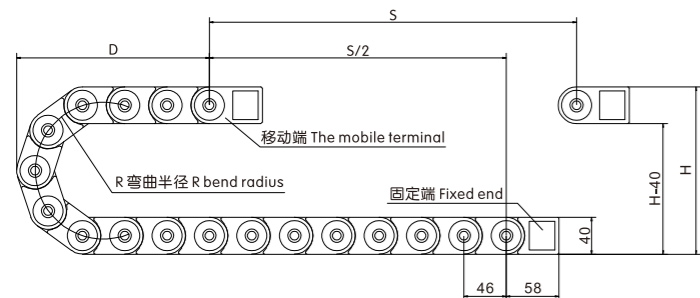

R	55	75	100	125	150
H	150	190	240	290	340
D	105	110	140	155	190
K	344	407	485	564	642

节距 = 46mm, 每米节数 = 22, 链长 = S/2+K, S=行程距离, K=π.R+"安全量"+1节距
Pitch = 46 mm, number of sections per meter = 22, chain length = S / 2 + K, S = stroke distance, K = π .R + "safe amount" +1 pitch

示意图 Delineation

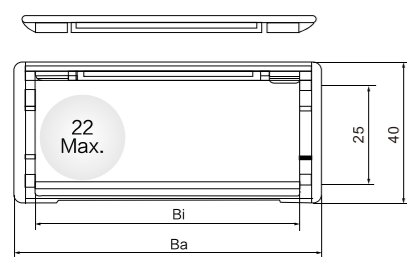

接头安装尺寸图 Connector installation dimensions

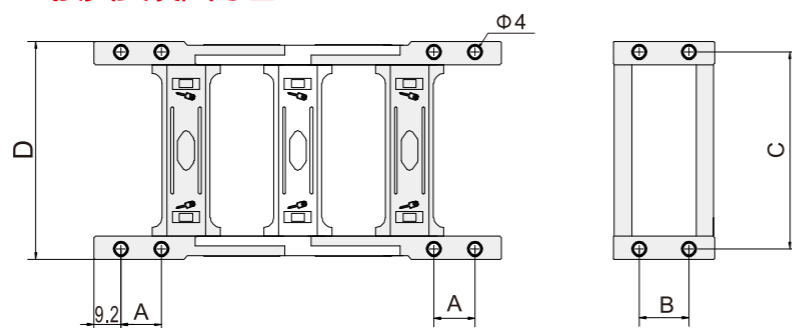

H25系列-桥式两侧可打开 H25 Series - Both sides of the bridge open

系列号 Serial No.	内高 Hi	内宽 Bi	外高 H	外宽 Ba	A	B	C	D	孔径(mm) Hole distance	孔边距 (mm) Hole margin
H25	25	25	40	45	16	16	37	46	4	9.2
	25	38	40	58	16	16	50	59	4	9.2
	25	50	40	70	16	16	62	71	4	9.2
	25	57	40	77	16	16	69	78	4	9.2
	25	60	40	80	16	16	72	81	4	9.2
	25	75	40	95	16	16	87	96	4	9.2
	25	77	40	97	16	16	89	98	4	9.2
	25	100	40	120	16	16	112	121	4	9.2
	25	103	40	123	16	16	115	124	4	9.2

H25系列-封闭两侧可打开

Series H25 - Closed to open on both sides



主要技术参数 Basic technical data

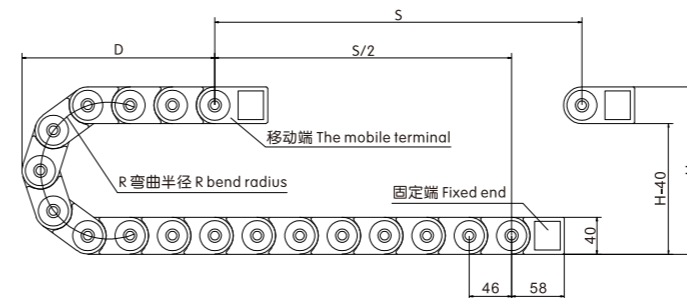

R	55	75	100	125	150
H	150	190	240	290	340
D	105	110	140	155	190
K	344	407	485	564	642

节距 = 46 mm, 每米节数 = 22, 链长 = S/2+K, S=行程距离, K=π.R+"安全量"+1节距
Pitch = 46 mm, number of sections per meter = 22, chain length = S / 2 + K, S = stroke distance, K = π .R + "safe amount" +1 pitch

示意图 Delineation

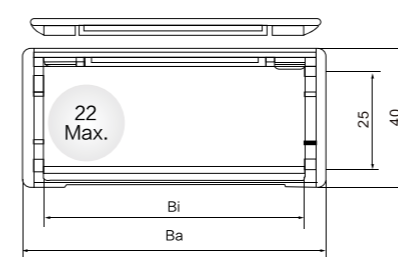

接头安装尺寸图 Connector installation dimensions

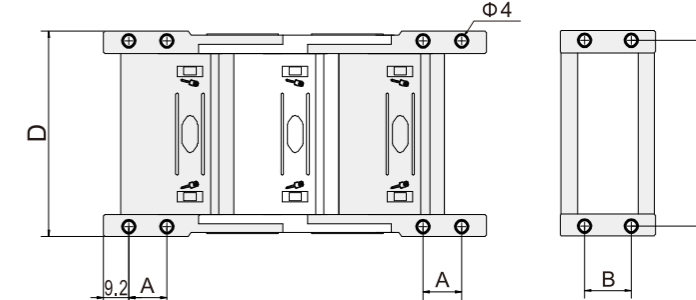

H25系列-封闭两侧可打开 Series 2H5 - Closed to open on both sides

系列号 Serial No.	内高 Hi	内宽 Bi	外高 H	外宽 Ba	A	B	C	D	孔径(mm) Hole distance	孔边距 (mm) Hole margin
H25	25	38	40	58	16	16	50	59	4	9.2
	25	50	40	70	16	16	62	71	4	9.2
	25	60	40	80	16	16	72	81	4	9.2
	25	75	40	95	16	16	87	96	4	9.2

H30系列-桥式两侧可打开

H30 Series – Both sides of the bridge open

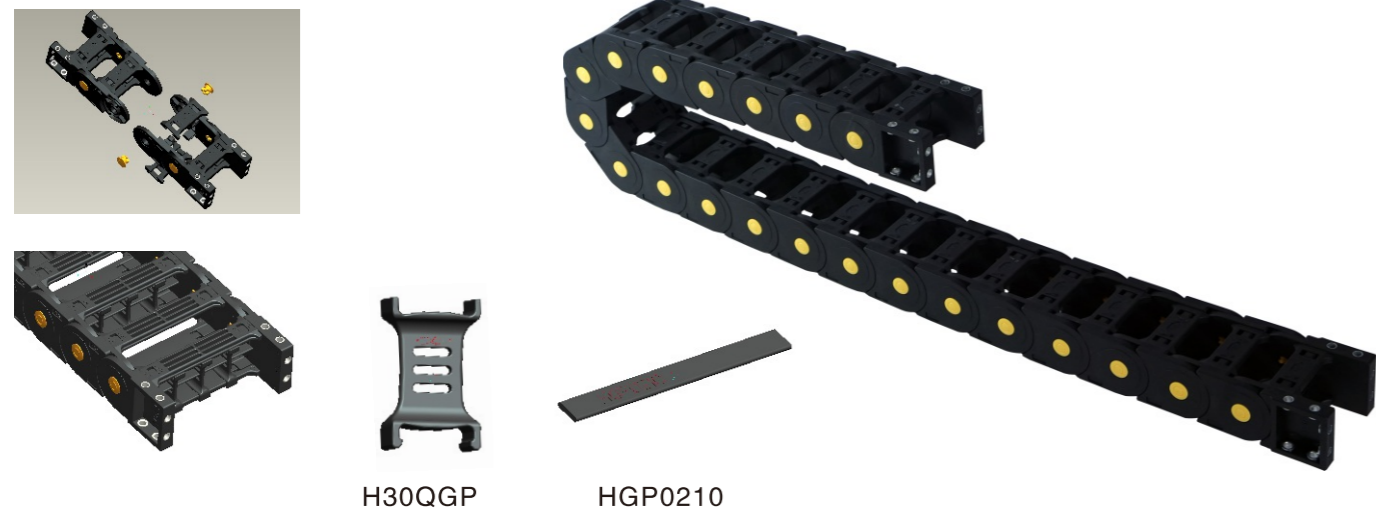

H30QGP

HGP0210

主要技术参数 Basic technical data

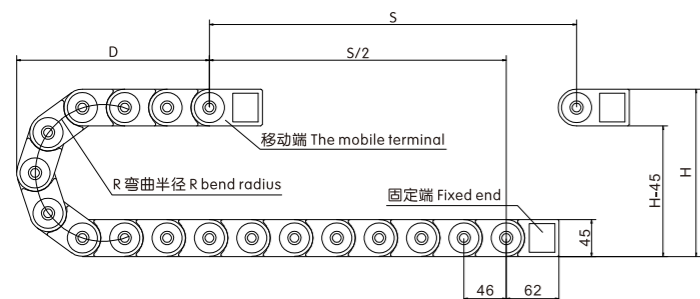

R	55	75	100	125	150
H	155	195	245	295	345
D	100	115	140	160	185
K	360	422	501	579	650

节距 = 46mm, 每米节数 = 22, 链长 = S/2+K, S=行程距离, K=π.R+"安全量"+1节距
Pitch = 46 mm, number of sections per meter = 22, chain length = S / 2 + K, S = stroke distance, K = π .R + "safe amount" +1 pitch

示意图 Delineation

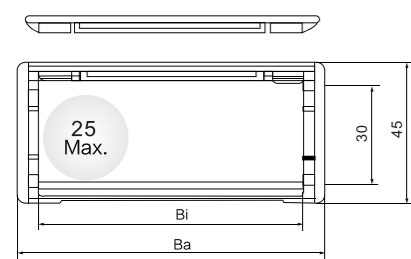

接头安装尺寸图 Connector installation dimensions

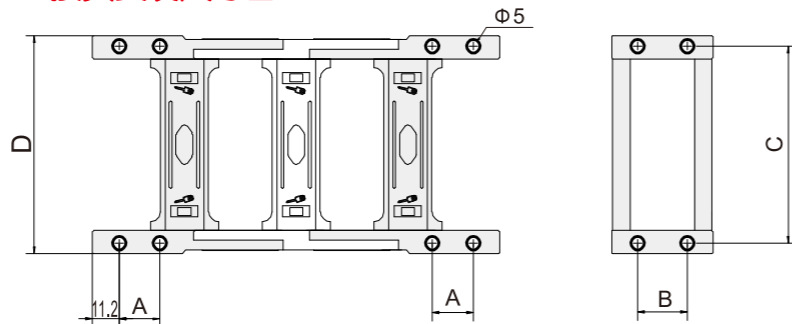

H30系列-桥式两侧可打开 H30 Series – Closed to open on both sides

系列号 Serial No.	内高 Hi	内宽 Bi	外高 H	外宽 Ba	A	B	C	D	孔径(mm) Hole distance	孔边距 (mm) Hole margin
H30	30	25	45	48	18	18	39	49	5	11.2
	30	38	45	61	18	18	52	62	5	11.2
	30	50	45	73	18	18	64	74	5	11.2
	30	57	45	80	18	18	71	81	5	11.2
	30	60	45	83	18	18	74	84	5	11.2
	30	75	45	98	18	18	89	99	5	11.2
	30	77	45	100	18	18	91	101	5	11.2
	30	100	45	123	18	18	114	124	5	11.2
	30	103	45	126	18	18	117	127	5	11.2

H30系列-封闭两侧可打开

Series H30 – Closed to open on both sides



主要技术参数 Basic technical data

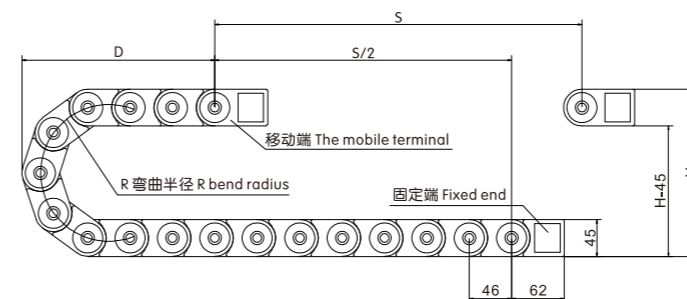

R	75	100	125	150
H	195	245	295	345
D	115	140	160	185
K	422	501	579	650

节距 = 46mm, 每米节数 = 22, 链长 = S/2+K, S=行程距离, K=π.R+"安全量"+1节距
Pitch = 46 mm, number of sections per meter = 22, chain length = S / 2 + K, S = stroke distance, K = π .R + "safe amount" +1 pitch

示意图 Delineation

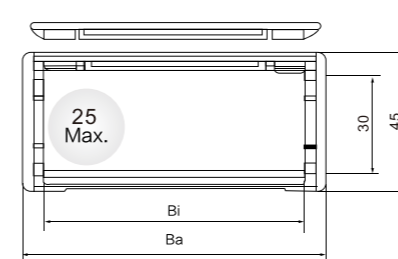

接头安装尺寸图 Connector installation dimensions

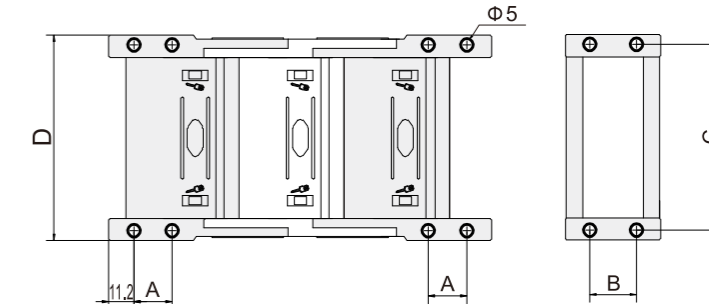

H30系列-封闭两侧可打开 Series H30 – Both sides of the bridge open

系列号 Serial No.	内高 Hi	内宽 Bi	外高 H	外宽 Ba	A	B	C	D	孔径(mm) Hole distance	孔边距 (mm) Hole margin
H30	30	38	45	61	18	18	52	62	5	11.2
	30	50	45	73	18	18	64	74	5	11.2
	30	60	45	83	18	18	74	84	5	11.2
	30	75	45	98	18	18	89	99	5	11.2

H35系列-桥式两侧可打开

H35 Series - Both sides of the bridge open

pund®



H35QGP

HGP0312

主要技术参数 Basic technical data

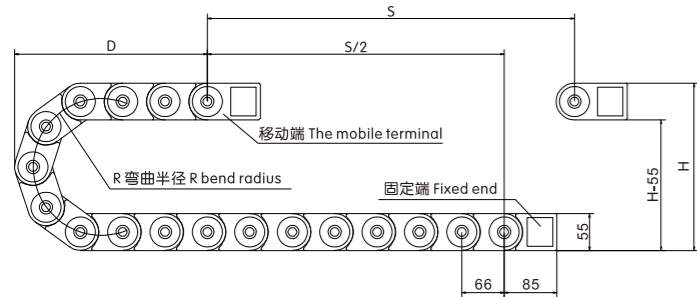

R	75	100	125	150	200
H	205	255	305	355	455
D	130	155	180	205	255
K	474	552	631	709	866

节距 = 66mm, 每米节数 = 15, 链长 = S/2 + K, S = 行程距离, K = π · R + "安全量" + 1节距
 Pitch = 66mm, Number of knots per meter = 15, Chain length = S / 2 + K, S = Travel distance, K = π · R + "Safe" + 1 pitch

示意图 Delineation

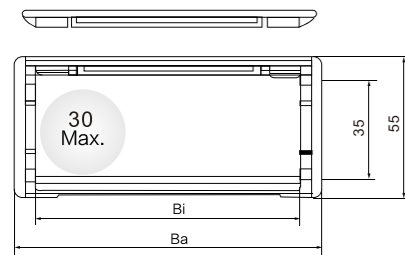

接头安装尺寸图 Connector installation dimensions

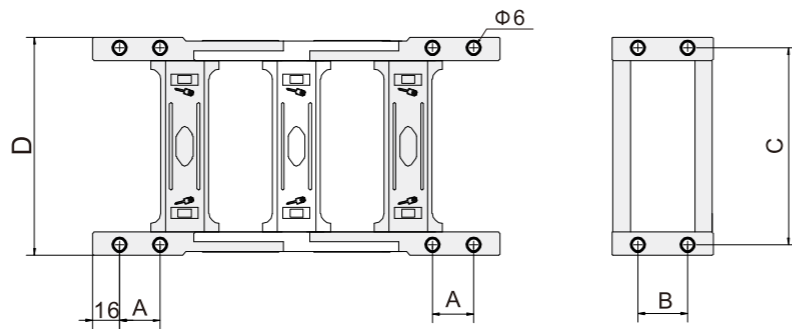

H35系列-桥式两侧可打开 H35 Series - Both sides of the bridge open

系列号 Serial No.	内高 Hi	内宽 Bi	外高 H	外宽 Ba	A	B	C	D	孔径(mm) Hole distance	孔边距 (mm) Hole margin
H35	35	50	55	77	24	24	65	78	6	16
	35	60	55	87	24	24	75	88	6	16
	35	75	55	102	24	24	90	103	6	16
	35	90	55	117	24	24	106	118	6	16
	35	100	55	127	24	24	116	128	6	16
	35	125	55	152	24	24	141	153	6	16
	35	150	55	177	24	24	166	178	6	16
	35	175	55	202	24	24	191	203	6	16
	35	200	55	227	24	24	216	228	6	16
35	250	55	277	24	24	266	278	6	16	

H35系列-封闭两侧可打开

Series H35 - Closed to open on both sides

pund®



主要技术参数 Basic technical data

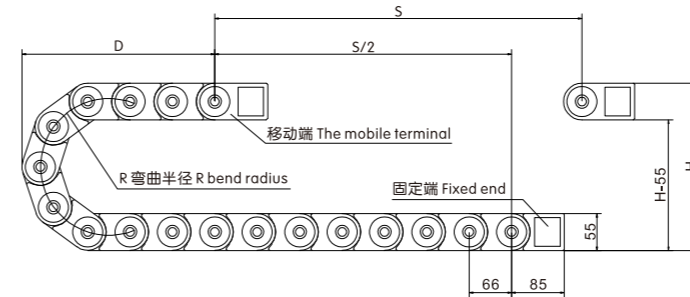

R	75	100	125	150	200
H	205	255	305	355	455
D	130	155	180	205	255
K	474	552	631	709	866

节距 = 66mm, 每米节数 = 15, 链长 = S/2 + K, S = 行程距离, K = π · R + "安全量" + 1节距
 Pitch = 66mm, Number of knots per meter = 15, Chain length = S / 2 + K, S = Travel distance, K = π · R + "Safe" + 1 pitch

示意图 Delineation

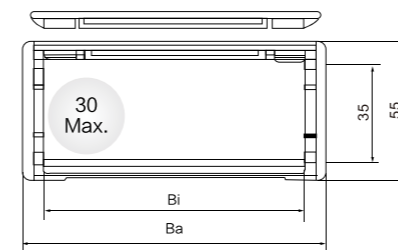

接头安装尺寸图 Connector installation dimensions

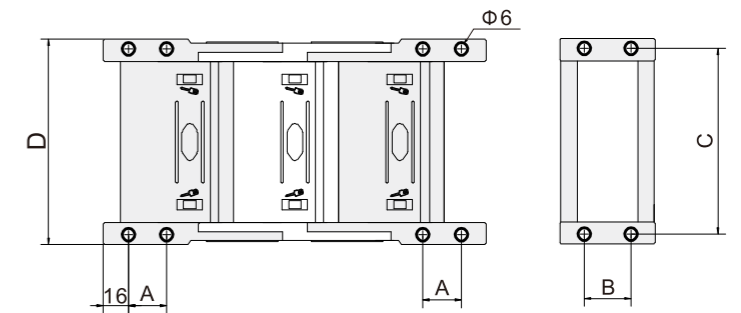

H35系列-封闭两侧可打开 Series H35 - Closed to open on both sides

系列号 Serial No.	内高 Hi	内宽 Bi	外高 H	外宽 Ba	A	B	C	D	孔径(mm) Hole distance	孔边距 (mm) Hole margin
H35	35	50	55	77	24	24	65	78	6	16
	35	75	55	102	24	24	90	103	6	16
	35	100	55	127	24	24	115	128	6	16
	35	125	55	152	24	24	141	153	6	16
	35	150	55	177	24	24	166	178	6	16
	35	200	55	227	24	24	216	228	6	16

H45系列-桥式两侧可打开

H45 Series - Both sides of the bridge open



主要技术参数 Basic technical data

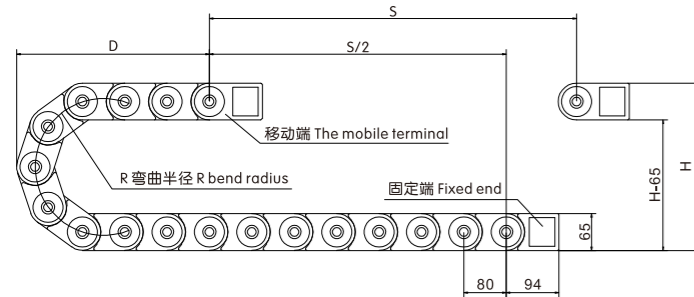

R	75	100	125	150	200	250
H	215	265	315	365	456	565
D	120	155	190	215	260	310
K	519	598	676	755	912	1069

节距 = 80mm, 每米节数 = 13, 链长 = S/2+K, S=行程距离, K=π.R+"安全量"+1节距
Pitch = 80 mm, number of sections per meter = 13, chain length = S / 2 + K, S = travel distance, K = π .R + "safe amount" +1 pitch

示意图 Delineation

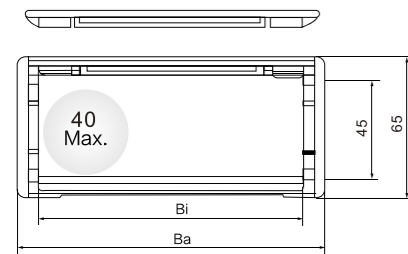

接头安装尺寸图 Connector installation dimensions

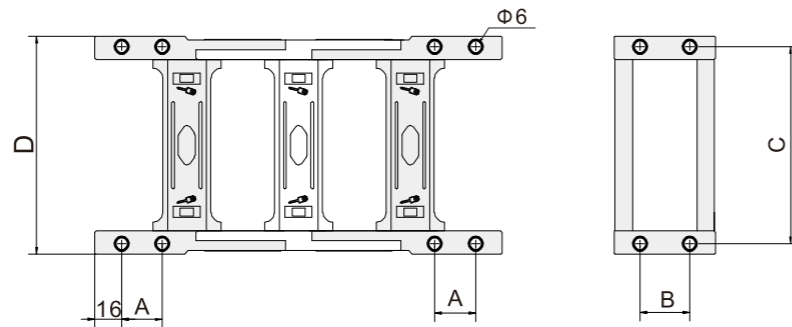

H45系列-桥式两侧可打开 H45 Series - Both sides of the bridge open

系列号 Serial No.	内高 Hi	内宽 Bi	外高 H	外宽 Ba	A	B	C	D	孔径(mm) Hole distance	孔边距 (mm) Hole margin
H45	45	50	65	80	24	26	68	84	6	16
	45	60	65	90	24	26	78	94	6	16
	45	75	65	105	24	26	93	109	6	16
	45	90	65	120	24	26	109	124	6	16
	45	100	65	130	24	26	119	134	6	16
	45	125	65	155	24	26	144	159	6	16
	45	150	65	180	24	26	169	184	6	16
	45	175	65	205	24	26	194	209	6	16
	45	200	65	230	24	26	219	234	6	16
	45	250	65	280	24	26	269	284	6	16

H45系列-封闭两侧可打开

Series H45 - Closed to open on both sides

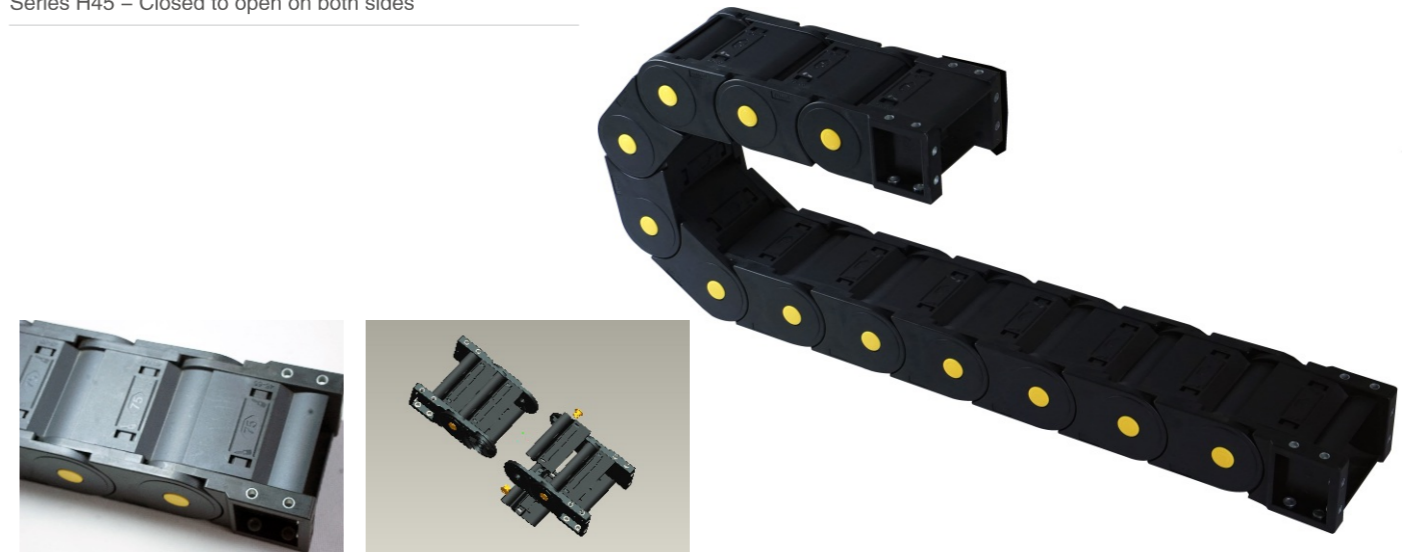

主要技术参数 Basic technical data

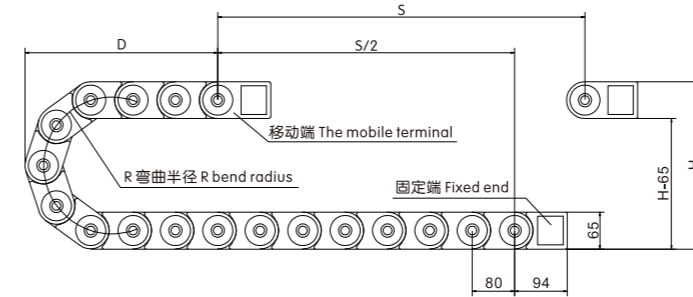

R	100	125	150	200	250*
H	265	315	365	456	565
D	155	190	215	260	310
K	598	676	755	912	1069

节距 = 80mm, 每米节数 = 13, 链长 = S/2+K, S=行程距离, K=π.R+"安全量"+1节距
Pitch = 80 mm, number of sections per meter = 13, chain length = S / 2 + K, S = travel distance, K = π .R + "safe amount" +1 pitch

示意图 Delineation

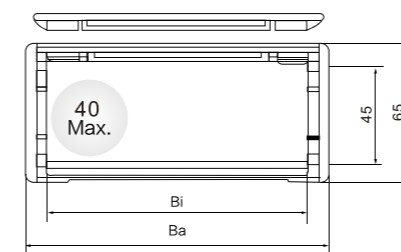

接头安装尺寸图 Connector installation dimensions

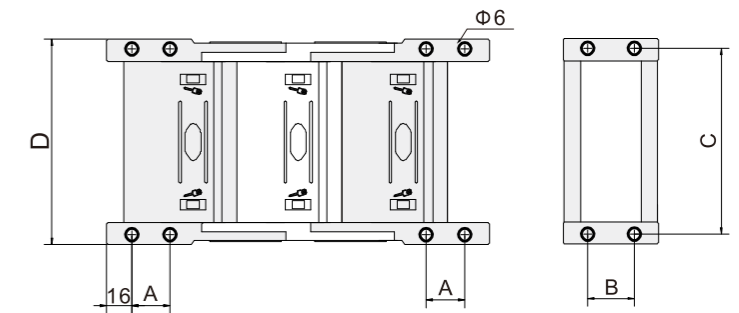

H45系列-封闭两侧可打开 Series H45 - Closed to open on both sides

系列号 Serial No.	内高 Hi	内宽 Bi	外高 H	外宽 Ba	A	B	C	D	孔径(mm) Hole distance	孔边距 (mm) Hole margin
H45	45	50	65	80	24	26	68	84	6	16
	45	75	65	105	24	26	93	109	6	16
	45	100	65	130	24	26	118	134	6	16
	45	125	65	155	24	26	144	159	6	16
	45	150	65	180	24	26	169	184	6	16
	45	175	65	205	24	26	194	209	6	16
	45	200	65	230	24	26	219	234	6	16

H55系列-桥式两侧可打开

H55 Series - Both sides of the bridge open



H55QGP

HGP0312

主要技术参数 Basic technical data

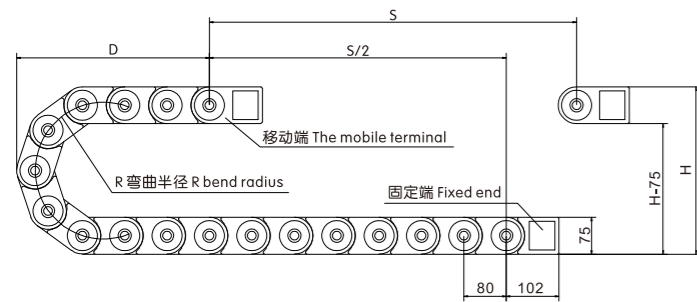

R	75	100	125	150	200	300*
H	225	275	325	375	475	675
D	160	180	195	235	300	400
K	551	629	708	786	943	1257

节距 = 80mm, 每米节数 = 13, 链长 = S/2+K, S=行程距离, K=π.R+"安全量"+1节距
Pitch = 80 mm, number of sections per meter = 13, chain length = S / 2 + K, S = travel distance, K = π .R + "safe amount" +1 pitch

示意图 Delineation

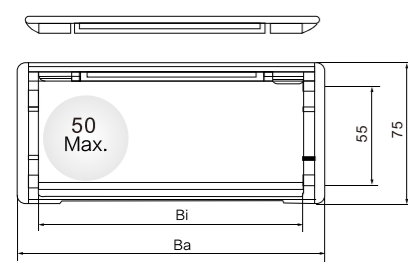

接头安装尺寸图 Connector installation dimensions

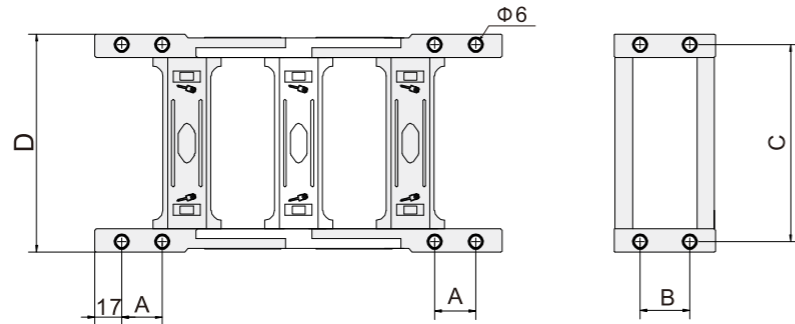

H55系列-桥式两侧可打开 Series H55 - Both sides of the bridge open

系列号 Serial No.	内高 Hi	内宽 Bi	外高 H	外宽 Ba	A	B	C	D	孔径(mm) Hole distance	孔边距 (mm) Hole margin
H55	55	50	75	83	30	30	69.5	85	6	17
	55	60	75	93	30	30	79.5	95	6	17
	55	75	75	108	30	30	94.5	110	6	17
	55	90	75	124	30	30	110.5	126	6	17
	55	100	75	134	30	30	120.5	136	6	17
	55	125	75	159	30	30	145.5	161	6	17
	55	150	75	184	30	30	170.5	186	6	17
	55	175	75	209	30	30	195.5	211	6	17
	55	200	75	234	30	30	210.5	236	6	17
	55	250	75	284	30	30	260.5	286	6	17

H55系列-封闭两侧可打开

Series H55 - Closed to open on both sides

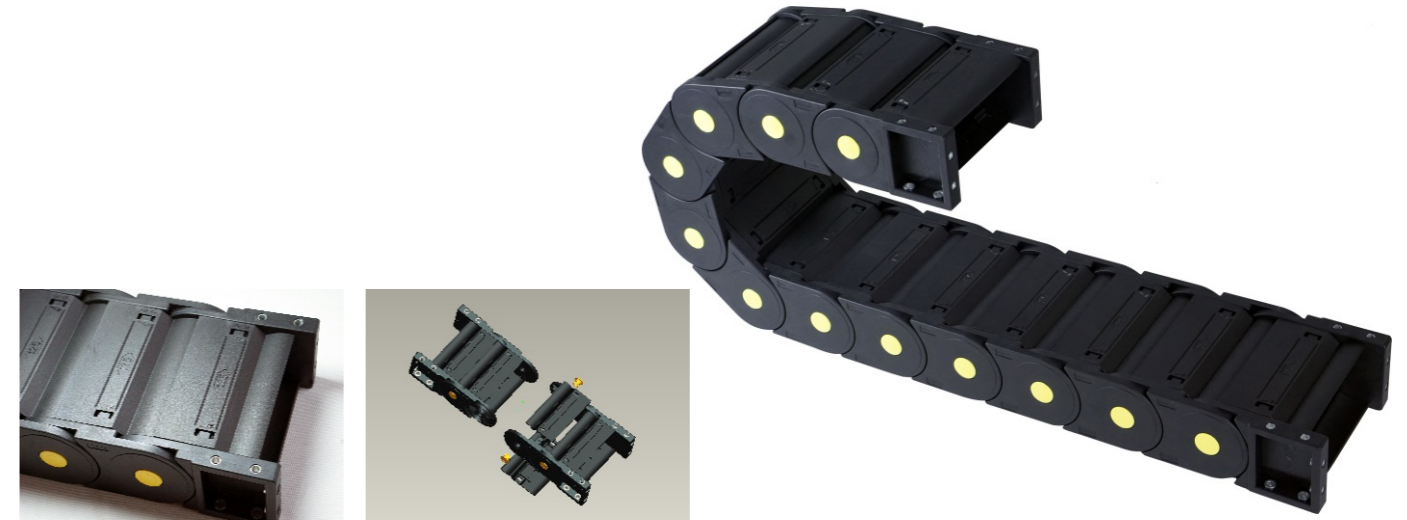

主要技术参数 Basic technical data

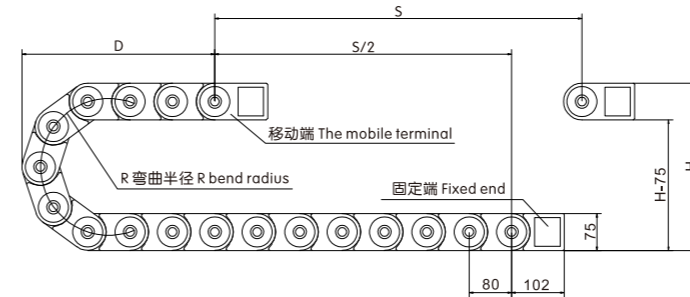

R	100	125	150	200	250*	300*
H	275	325	375	475	575	675
D	180	195	235	300	300	400
K	629	708	786	943	1100	1257

节距 = 80mm, 每米节数 = 13, 链长 = S/2+K, S=行程距离, K=π.R+"安全量"+1节距
Pitch = 80 mm, number of sections per meter = 13, chain length = S / 2 + K, S = travel distance, K = π .R + "safe amount" +1 pitch

示意图 Delineation

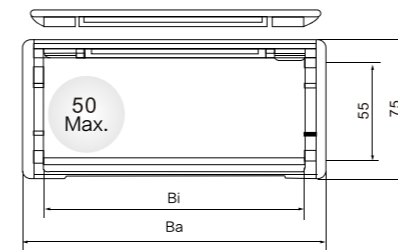

接头安装尺寸图 Connector installation dimensions

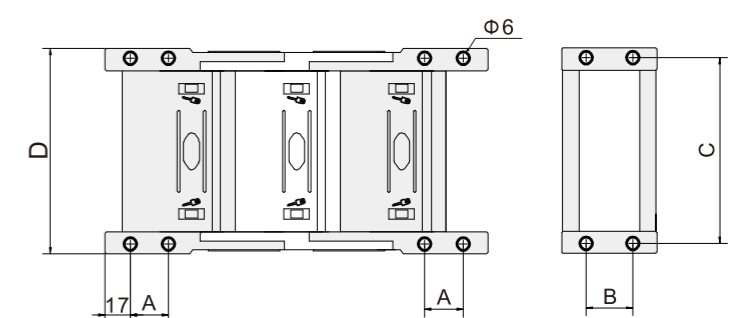

H55系列-封闭两侧可打开 Series H55 - Closed to open on both sides

系列号 Serial No.	内高 Hi	内宽 Bi	外高 H	外宽 Ba	A	B	C	D	孔径(mm) Hole distance	孔边距 (mm) Hole margin
55	55	50	75	83	30	30	69.5	85	6	17
	55	75	75	108	30	30	94.5	110	6	17
	55	100	75	133	30	30	119.5	135	6	17
	55	125	75	159	30	30	145.5	161	6	17
	55	150	75	184	30	30	170.5	186	6	17
	55	175	75	209	30	30	195.5	211	6	17
	55	200	75	234	30	30	220.5	236	6	17

H65系列-桥式两侧可打开

H65 Series – Both sides of the bridge open

pund®



H65QGP

HGP0312

主要技术参数 Basic technical data

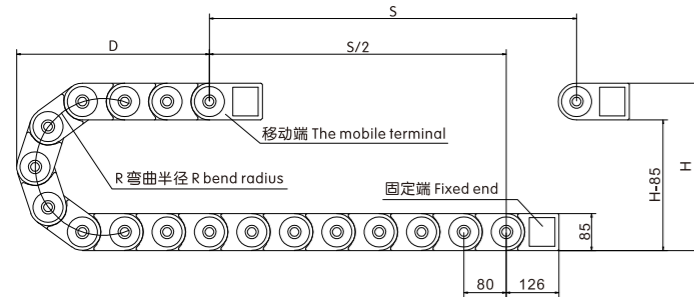

R	125	150	200	250	300
H	335	385	485	585	685
D	200	220	270	325	365
K	739	818	975	1132	1288

节距 = 80mm, 每米节数 = 13, 链长 = S/2+K, S=行程距离, K=π.R+"安全量"+1节距
Pitch = 80 mm, number of sections per meter = 13, chain length = S / 2 + K, S = travel distance, K = π .R + "safe amount" +1 pitch

示意图 Delineation

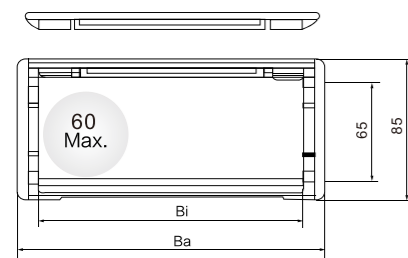

接头安装尺寸图 Connector installation dimensions

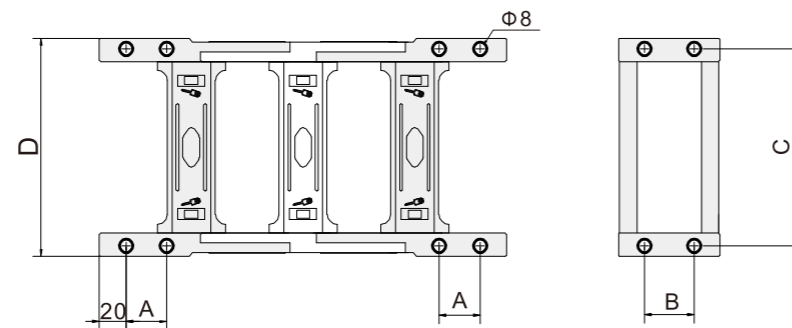

H65系列-桥式两侧可打开 H65 Series – Both sides of the bridge open

系列号 Serial No.	内高 Hi	内宽 Bi	外高 H	外宽 Ba	A	B	C	D	孔径(mm) Hole distance	孔边距 (mm) Hole margin
H65	65	50	85	86	35	45	72	92	8	20
	65	60	85	96	35	45	82	102	8	20
	65	75	85	111	35	45	97	117	8	20
	65	90	85	127	35	45	113	133	8	20
	65	100	85	137	35	45	123	143	8	20
	65	125	85	162	35	45	148	168	8	20
	65	150	85	187	35	45	173	193	8	20
	65	175	85	212	35	45	198	218	8	20
	65	200	85	237	35	45	223	243	8	20
65	250	85	287	35	45	273	293	8	20	

H65系列-封闭两侧可打开

Series H65 – Closed to open on both sides

pund®

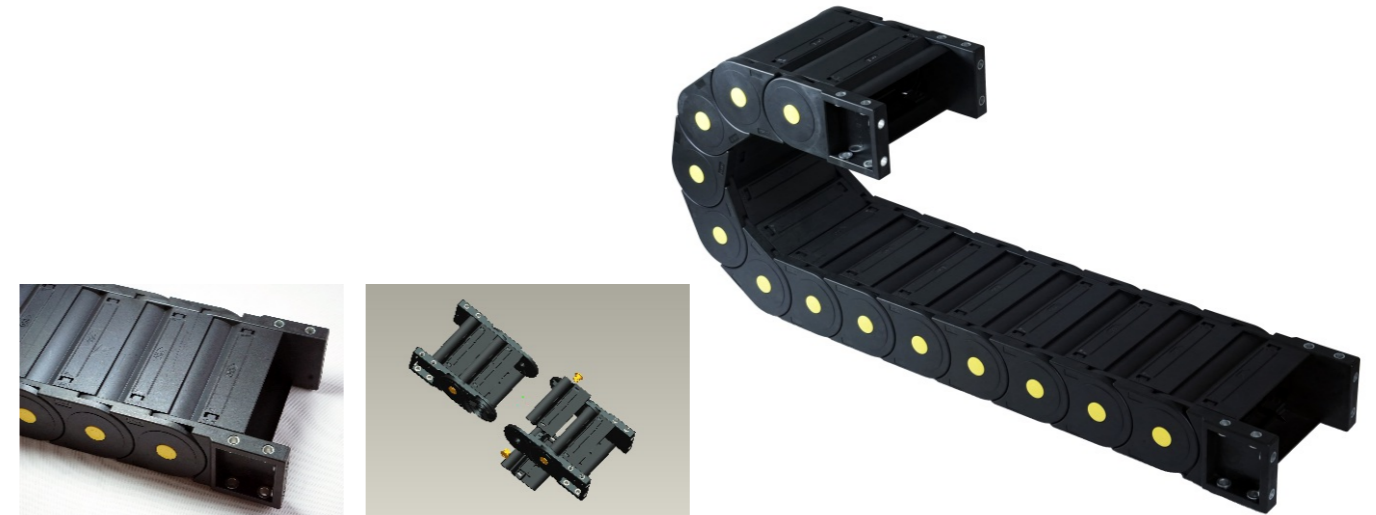

主要技术参数 Basic technical data

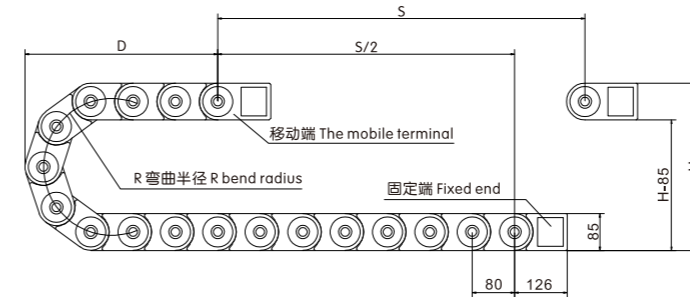

R	125	150	200	250	300
H	335	385	485	585	685
D	200	270	270	325	365
K	739	975	975	1132	1288

节距 = 80mm, 每米节数 = 13, 链长 = S/2+K, S=行程距离, K=π.R+"安全量"+1节距
Pitch = 80 mm, number of sections per meter = 13, chain length = S / 2 + K, S = travel distance, K = π .R + "safe amount" +1 pitch

示意图 Delineation

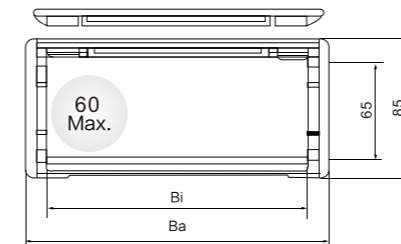

接头安装尺寸图 Connector installation dimensions

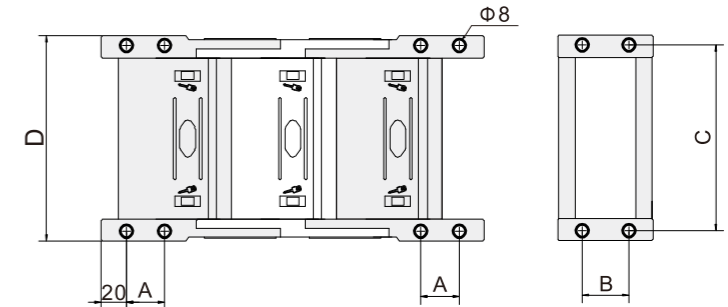

H65系列-封闭两侧可打开 Series H65 – Closed to open on both sides

系列号 Serial No.	内高 Hi	内宽 Bi	外高 H	外宽 Ba	A	B	C	D	孔径(mm) Hole distance	孔边距 (mm) Hole margin
H65	65	50	85	86	35	45	72	92	8	20
	65	75	85	111	35	45	97	117	8	20
	65	100	85	136	35	45	122	142	8	20
	65	125	85	162	35	45	148	168	8	20
	65	150	85	187	35	45	173	193	8	20
	65	175	85	212	35	45	198	218	8	20
	65	200	85	237	35	45	223	243	8	20
	65	250	85	287	35	45	273	293	8	20